



MONOGEN[®]

A milk-based powdered formula containing protein as a casein/whey mix, carbohydrate, fat (high in Medium Chain Triglycerides [MCT], low in Long Chain Triglycerides [LCT]), vitamins and minerals.

Indications:

- Long-chain fatty acid oxidation disorders
- Chylolthorax
- Fat malabsorption
- Short bowel syndrome

Suitable for individuals over 1 year of age.

Nutrition Information:

Nutrients	Per 100 g of powder	Per 100 kcal
Calories, kcal	441	100
Protein, g	12.8	2.9
Fat, g	12.9	2.9
MCT, g	10.9	2.5
LCT, g	2.0	0.45
Linoleic acid, mg	869	197
α-Linolenic acid, mg	179	39.7
ARA, mg	60	14.1
DHA, mg	60	14.1
Carbohydrate, g	68.6	15.6
Vitamins		
Vitamin A, IU (mcg RE)	1158 (348)	263 (79.1)
Vitamin D ₃ , IU (mcg)	428 (10.7)	97.2 (2.4)
Vitamin E, IU (mg α-TE)	6.6 (4.4)	1.5 (1.0)
Vitamin K, mcg	16.1	3.7
Thiamin, mg	0.32	0.07
Riboflavin, mg	0.47	0.11
Vitamin B ₆ , mg	0.40	0.09
Vitamin B ₁₂ , mcg	0.57	0.13
Niacin, mg	2.7	0.61
Folic Acid, mcg	63.2	14.4
Pantothenic Acid, mg	2.0	0.45
Biotin, mcg	14.0	3.2
Vitamin C, mg	53.9	12.2
Choline, mg	90.9	20.6
Inositol, mg	78.7	17.9

Minerals	Per 100 g of powder	Per 100 kcal
Calcium, mg	329	74.4
Phosphorous, mg	198	44.7
Magnesium, mg	39.6	9.0
Iron, mg	6.0	1.4
Zinc, mg	4.1	0.93
Manganese, mg	0.03	0.01
Copper, mcg	323	73.2
Iodine, mcg	79.6	18.1
Molybdenum, mcg	21.6	4.9
Chromium, mcg	8.9	2.0
Selenium, mcg	15.6	3.6
Sodium, mg	189	42.9
Potassium, mg	357	81.2
Chloride, mg	271	61.6

Ordering/Reimbursement Information for Monogen®:

Product Code	Reimbursement Code	HCPCS Code*	Product Packaging	Calories Per Can
106033 - Unflavored	49735-0160-33	B4150, B4158, B4157, or B4162	6 x 400 g (14.1 oz)	1764

* S9435 = For individuals who submit their bills to insurance on their own.

Ingredients:

Maltodextrin, Skim Milk Powder, Refined Vegetable Oil (Modified Palm Kernel And/Or Coconut Oil [Medium Chain Triglycerides]), Whey Protein Concentrate (Milk), Caseinate (Milk), Refined Walnut Oil, Sodium Citrate, Corn Syrup Solids, Potassium Chloride, Calcium Carbonate, Magnesium Hydrogen Phosphate, C. cohnii Oil, Choline Chloride, M. alpina Oil, L-Valine, Inositol, L-Ascorbic Acid, Refined High Oleic Sunflower Oil, L-Tryptophan, Sodium L-Ascorbate, Taurine, Ferrous Sulfate, Zinc Sulfate, L-Carnitine, DL-Alpha Tocopheryl Acetate, Niacinamide, DL-Alpha Tocopherol, Calcium D-Pantothenate, Copper Sulfate, Pyridoxine Hydrochloride, Vitamin A Acetate, Thiamine Hydrochloride, Riboflavin, Folic Acid, Potassium Iodide, Ascorbyl Palmitate, Manganese Sulfate, Chromium Chloride, Sodium Molybdate, Phylloquinone, D-Biotin, Sodium Selenite, Cholecalciferol.

Contains: Milk, Walnut Oil, Coconut Oil.

Mixing Instructions:

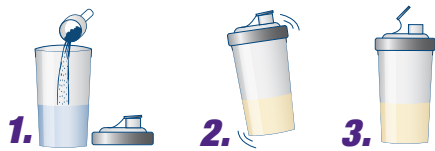

1. Measure the required amount of warmed water into a covered container.
2. Add the prescribed amount of Monogen to the water. The scoop provided in the can measures 5.6 g (level and unpacked).
3. Cover and shake until the powder has dissolved.

The following are guidelines for achieving desired concentrations:

Concentration	Powder	Water	Final Volume
22 kcal/30 mL (0.74 kcal/mL)	16.8 g (3 Scoops)	90 mL (3 fl oz)	100 mL
30 kcal/30 mL (1.0 kcal/mL)	22.7 g (4 Scoops)	80 mL (2 ½ fl oz)	100 mL

Unpacked, level scoops are approximations only. For accuracy, use a gram scale.

Once prepared, the formula should be stored in a refrigerator and kept no longer than 12 hours from the time of preparation. Shake or stir Monogen immediately before use.

Storage:

Store in a cool, dry place. Once opened, use contents within one month. Replace lid firmly after use.

Important Notice:

Must only be used under medical supervision. For oral or tube feedings. Not for parenteral use. Not suitable as a sole source of nutrition. For supplemental use in individuals over 1 year of age.

