

PKU LOPHLEX® POWDER

A phenylalanine-free, powdered medical food containing a balanced mix of essential and non-essential amino acids, vitamins, minerals and trace elements.



Indication: Phenylketonuria
Suitable for individuals 9 years of age and older.

Nutrition Information:

Nutrients	Per 100 g Powder	Per 14.3 g Powder (1 pouch)
Calories	286	41
Protein Equivalent, g	70	10
Fat, g	0.2	0.03
Carbohydrate, g	1.0	0.14
Amino Acids, g		
L-Alanine	3.3	0.47
L-Arginine	5.8	0.83
L-Aspartic Acid	5.4	0.77
L-Cystine	2.2	0.31
Glycine	5.1	0.73
L-Histidine	3.3	0.47
L-Isoleucine	5.1	0.73
L-Leucine	8.7	1.24
L-Lysine	5.9	0.84
L-Methionine	1.4	0.2
L-Phenylalanine	Nil Added	Nil Added
L-Proline	6.2	0.89
L-Serine	3.8	0.54
L-Threonine	4.3	0.61
L-Tryptophan	1.7	0.24
L-Tyrosine	7.8	1.12
L-Valine	5.6	0.80
L-Carnitine	0.06	0.01
Taurine	0.11	0.02
L-Glutamine	3.95	0.56

Vitamins	Per 100 g Powder	Per 14.3 g Powder (1 pouch)
Vitamin A, IU (mcg RE)	3896 (1170)	557 (167)
Vitamin D ₃ , IU (mcg)	580 (14.5)	82.9 (2.1)
Vitamin E, IU (mg α-TE)	32 (21.5)	4.6 (3.1)
Vitamin K ₁ , mcg	143	20.4
Thiamine, mg	1.6	0.23
Riboflavin, mg	1.7	0.24
Vitamin B ₆ , mg	2.8	0.4
Vitamin B ₁₂ , mcg	5.5	0.79
Niacin, mg	10	1.4
Folic Acid, mcg	860	123
Pantothenic Acid, mg	8.6	1.2
Biotin, mcg	43	6.1
Vitamin C, mg	110	15.7
Choline, mg	720	103
Inositol, mg	140	20
Minerals		
Calcium, mg	2070	296
Phosphorus, mg	1990	285
Magnesium, mg	535	76.5
Iron, mg	25.7	3.7
Zinc, mg	15.8	2.3
Manganese, mg	3.1	0.44
Copper, mcg	1430	204
Iodine, mcg	229	32.7
Molybdenum, mcg	65	9.3
Chromium, mcg	46	6.6
Selenium, mcg	101	14.4
Sodium, mg	<20	<3
Potassium, mg	<40	<6
Chloride, mg	<1	<1

Ordering/Reimbursement Information for PKU Lophlex® Powder:

Product Code	Reimbursement Code	HCPCS Code*	Product Packaging	Calories Per Pouch
49418 - Berry	49735-0121-69	B4157 or B4162	30 x 14.3 g (0.5 oz)	41
49417 - Orange	49735-0121-67	B4157 or B4162	30 x 14.3 g (0.5 oz)	41

* S9435 = For individuals who submit their bills to insurance on their own.

Ingredients:

Berry: L-Lysine L-Aspartate, L-Leucine, L-Tyrosine, L-Proline, L-Arginine, Calcium Phosphate Tribasic, L-Valine, Glycine, L-Isoleucine, L-Threonine, Magnesium Hydrogen Phosphate, L-Glutamine, L-Serine, L-Histidine, L-Alanine, Citric Acid, L-Cystine, N-Acetyl-L-Methionine, Choline Bitartrate, L-Tryptophan, Calcium Phosphate Monobasic, Guar Gum, Artificial Flavor, Soy Lecithin, L-Ascorbic Acid, M-Inositol, Acesulfame Potassium, Taurine, Ferrous Sulfate, L-Carnitine, Zinc Sulfate, DL-Alpha Tocopheryl Acetate, Niacinamide, Manganese Sulfate, Calcium D-Pantothenate, Cupric Sulfate, Pyridoxine Hydrochloride, Thiamine Hydrochloride, Riboflavin, Vitamin A Acetate, Folic Acid, Beet Juice Concentrate (For Color), Potassium Iodide, Chromium Chloride, Sodium Selenite, Sodium Molybdate, Phylloquinone, D-Biotin, Vitamin D₃, Cyanocobalamin.

Contains: Soy.

Orange: L-Lysine L-Aspartate, L-Leucine, L-Tyrosine, L-Proline, L-Arginine, Calcium Phosphate Tribasic, L-Valine, Glycine, L-Isoleucine, Magnesium Hydrogen Phosphate, L-Threonine, L-Glutamine, L-Serine, L-Histidine, L-Alanine, Citric Acid, L-Cystine, N-Acetyl-L-Methionine, Choline Bitartrate, L-Tryptophan, Calcium Phosphate Monobasic, Artificial Flavor, Guar Gum, Soy Lecithin, L-Ascorbic Acid, M-Inositol, Acesulfame Potassium, Taurine, Ferrous Sulfate, L-Carnitine, Zinc Sulfate, DL-Alpha Tocopheryl Acetate, Niacinamide, Manganese Sulfate, Calcium D-Pantothenate, Cupric Sulfate, Pyridoxine Hydrochloride, Thiamine Hydrochloride, Riboflavin, Vitamin A Acetate, Beet Juice Concentrate (For Color), Beta Carotene (For Color), Folic Acid, Potassium Iodide, Chromium Chloride, Sodium Selenite, Sodium Molybdate, Phylloquinone, D-Biotin, Vitamin D₃, Cyanocobalamin.

Contains: Soy.

Mixing Instructions:

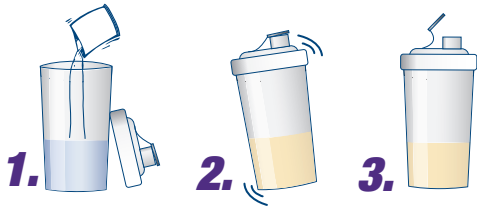

1. Simply add 1 pouch (14.3 g) to approx. 2.5 fl oz (70 mL) of cold water. Dilution may be adjusted to personal taste.
2. Cover with a tight-fitting lid and shake until fully blended.
3. Enjoy immediately or store formula in a refrigerator for no more than 24 hours from time of preparation. Shake or stir prepared stored formula again before use.

Storage:

Store in a cool, dry place, away from sunlight.
Avoid extreme temperatures.

Important Notice:

Must only be used under medical supervision. Not for parenteral use. Not suitable as a sole source of nutrition. Only suitable for individuals 9 years of age and older with proven phenylketonuria (PKU).

