



Must Be Used Under Medical Supervision



GLUTARADE® ESSENTIAL

A lysine-free, low tryptophan, powdered medical food containing a balanced mix of essential and non-essential amino acids, carbohydrates, fat, vitamins, minerals and trace elements.

Indications: Glutaric Aciduria Type 1
Suitable for individuals over 1 year of age.

Nutrition Information:

Nutrients	Per 100 g of powder	Per 40 g powder (1 scoop)
Calories	385	154
Protein Equivalent, g	25	10
Fat, g	13	5
Saturated, g	3.1	1.2
Monounsaturated, g	6.9	2.8
Polyunsaturated, g	2.9	1.2
Linoleic Acid, mg	1936	774
α -Linolenic Acid, mg	730	292
Carbohydrate, g	45	18
Fiber, g	3.9	1.5
Amino Acids, g		
L-Alanine	1.20	0.48
L-Arginine	2.7	1.08
L-Asparagine	1.8	0.72
L-Cystine	0.45	0.18
L-Glutamic Acid	0.9	0.36
L-Glutamine	4.51	1.8
Glycine	0.6	0.24
L-Histidine	0.9	0.36
L-Isoleucine	2.1	0.84
L-Leucine	3.46	1.38
L-Lysine	Nil Added	Nil Added
L-Methionine	1.02	0.41
L-Ornithine	0.6	0.24
L-Phenylalanine	1.59	0.64
L-Proline	1.5	0.6
L-Serine	0.6	0.24
L-Threonine	1.59	0.64
L-Tryptophan	0.15	0.06
L-Tyrosine	1.8	0.72
L-Valine	2.4	0.96
L-Carnitine	0.04	0.01
Taurine	0.15	0.06

Vitamins	Per 100 g of powder	Per 40 g powder (1 scoop)
Vitamin A, IU (mcg RE) (25% as beta-carotene)	1700 (637)	680 (255)
Vitamin D ₃ , IU (mcg)	600 (15)	240 (6)
Vitamin E, IU (mg α -TE)	19.1 (12.8)	7.6 (5.1)
Vitamin K ₁ , mcg	70	28
Thiamine, mg	1.5	0.6
Riboflavin, mg	1.5	0.6
Vitamin B ₆ , mg	1.4	0.56
Vitamin B ₁₂ , mcg	3	1.2
Niacin, mg	15.5	6.2
Folic Acid, mcg	300	120
Pantothenic Acid, mg	7.5	3
Biotin, mcg	30	12
Vitamin C, mg	60	24
Choline, mg	313	125
Inositol, mg	50	20
Minerals		
Calcium, mg	1257	503
Phosphorus, mg	787	315
Magnesium, mg	201	80
Iron, mg	11.3	4.5
Zinc, mg	10	4
Manganese, mg	1.9	0.76
Copper, mcg	1000	400
Iodine, mcg	115	46
Molybdenum, mcg	31	12.4
Chromium, mcg	21	8.6
Selenium, mcg	63	25
Sodium, mg	384	154
Potassium, mg	874	350
Chloride, mg	475	190

Ordering/Reimbursement Information for GlutarAde® Essential:

Product Code	Reimbursement Code	HCPCS Code*	Product Packaging	Calories Per Can
120462 - Vanilla	00847-0754-22	B4157 or B4162	4 x 454 g (1 lb)	1748

* S9435 = For individuals who submit their bills to insurance on their own.

Ingredients:

Sugar, Modified Corn Starch, Canola Oil, Maltodextrin, Safflower Oil, Dextrin, L-Glutamine, L-Leucine, Natural and Artificial Flavors, L-Arginine, Dicalcium Phosphate, L-Valine, L-Isoleucine, L-Asparagine Monohydrate. Contains 2% Or Less Of The Following: L-Tyrosine, Tricalcium Phosphate, L-Phenylalanine, L-Threonine, L-Proline, Potassium Citrate, L-Ornithine-Alpha Ketoglutarate, L-Alanine, Coconut Oil, Soybean Oil, L-Methionine, Sodium Citrate, Potassium Chloride, L-Glutamic Acid, L-Histidine, Choline Bitartrate, Glycine, L-Serine, L-Cystine, Flaxseed Oil, Magnesium Oxide, Ascorbyl Palmitate, Mixed Tocopherols, Rosemary Extract, Silicon Dioxide, L-Tryptophan, Taurine, Sodium Chloride, Ascorbic Acid, Inositol, Ferric Orthophosphate, Vitamin E Acetate, L-Carnitine, Niacinamide, Calcium Phosphate, Zinc Oxide, Sucralose, Calcium D-Pantothenate, Copper Gluconate, Vitamin K₁, Vitamin D₃, Manganese Sulfate, Vitamin A Palmitate, Mono- And Diglycerides, D-Biotin, Beta-Carotene, Pyridoxine Hydrochloride, Potassium Iodide, Riboflavin, Thiamine Mononitrate, Sodium Selenite, Folic Acid, Vitamin B₁₂, Chromium Chloride, Sodium Molybdate.

Contains: Coconut Oil, Soybean Oil.

Mixing Instructions:

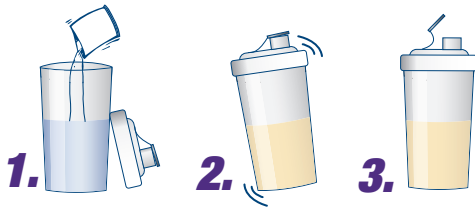

1. Simply add 1 pouch or scoop (40 g) to approx. 7 fl oz (210 mL) of cold water. Dilution may be adjusted to personal taste. For greater accuracy, use a gram scale.
2. Cover with a tight-fitting lid and shake until fully blended.
3. Enjoy immediately or store formula in a refrigerator for no more than 24 hours from time of preparation. Shake or stir prepared stored formula again before use.

Best served chilled.

Storage:

Store unopened cans at room temperature away from sunlight. Avoid extreme temperatures. Once a can is opened, reseal with lid provided and use within one month.

Important Notice:

Must only be used under medical supervision. For oral or tube feedings. Not for parenteral use. Not suitable as a sole source of nutrition. Only suitable for individuals over 1 year of age with proven Glutaric Aciduria Type 1 (GA-1).

